

LL1-CV-DA

12-24v Dimmable constant voltage DALI LED driver extension

The LL1-CV-DA DALI dimmable extension unit is designed to be used with the Helvar constant voltage LED drivers, creating solutions for decorative lighting.

- DALI control input, 0.1 %-100 % dimming range
- 1 kHz PWM dimming frequency
- Stand-by power < 0.1 W
- Suitable for Class I, II or SELV luminaire and Independent use
- Duplicate terminals for parallel connection
- DALI input is double insulated from input and output



Connections

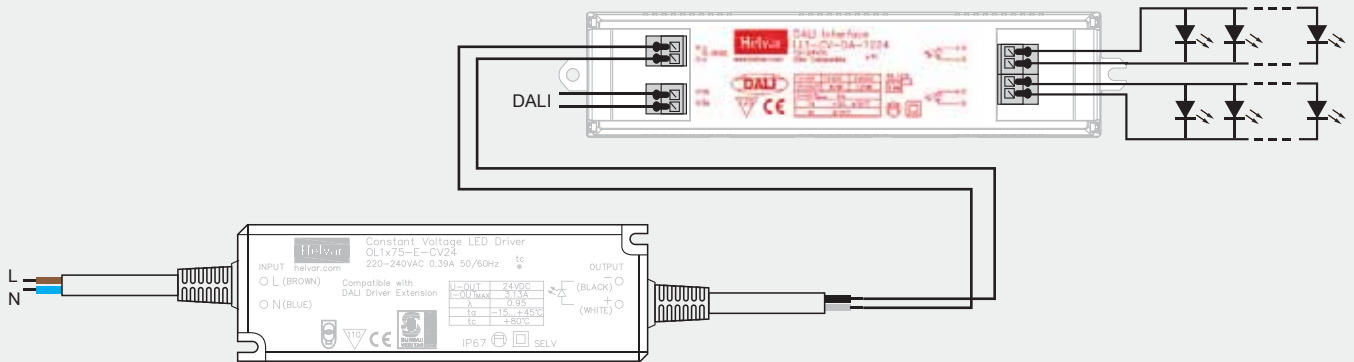

Note: Output voltage is PWM modulated and equal to CV driver output voltage

Input Characteristics

Voltage range 10.8 - 26.4 VDC

Load Output

Output current (I-OUT) Maximum 5 A*
Max output power 120 W

	U-IN 12 V	24 V
P-OUT (max)	60 W	120 W
I-OUT (max)	5 A*	5 A*
U-OUT	12 V	24 V

* DALI LED driver extension must be used with power supply with current limiting of max 5A and proper short circuit protection.

Operating Conditions and Characteristics

Max.temperature at tc point 70 °C
Ambient temperature range -20...+50 °C
Storage temperature range -40...+80 °C
Maximum relative humidity no condensation
Life time 50 000h, at TC max

Connections and Mechanical Data

Wire size 0.5 - 1.5 mm²
Wire type solid core and fine-stranded
Maximum driver to LED wire length 5 m
Weight 70 g
IP rating IP20

